

KM-S4850w

INSTALLATION GUIDE

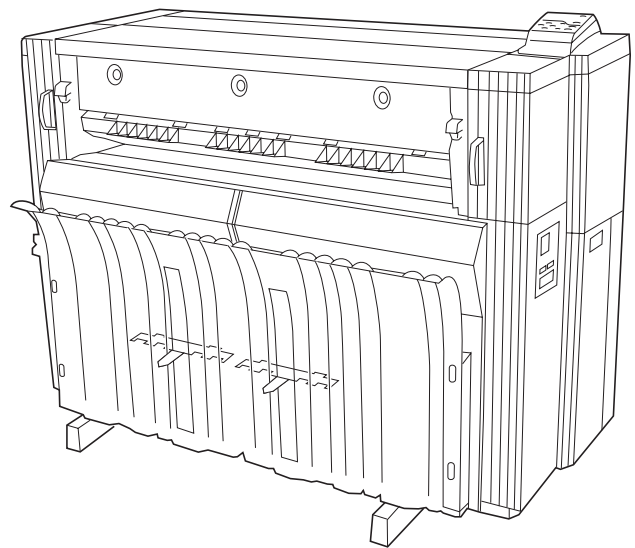

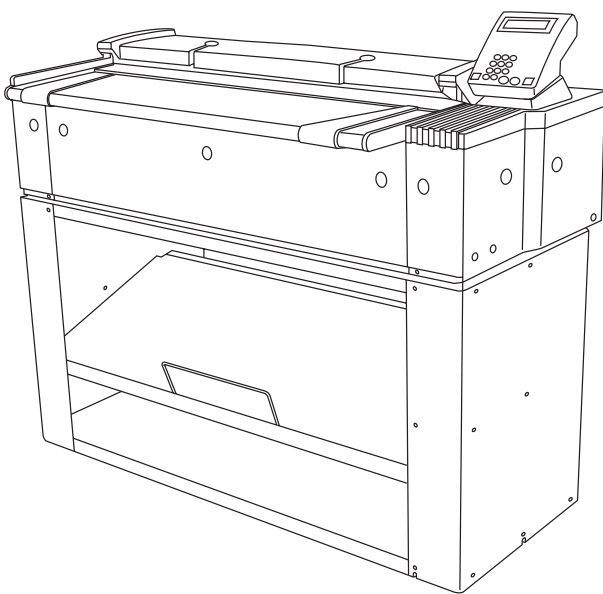
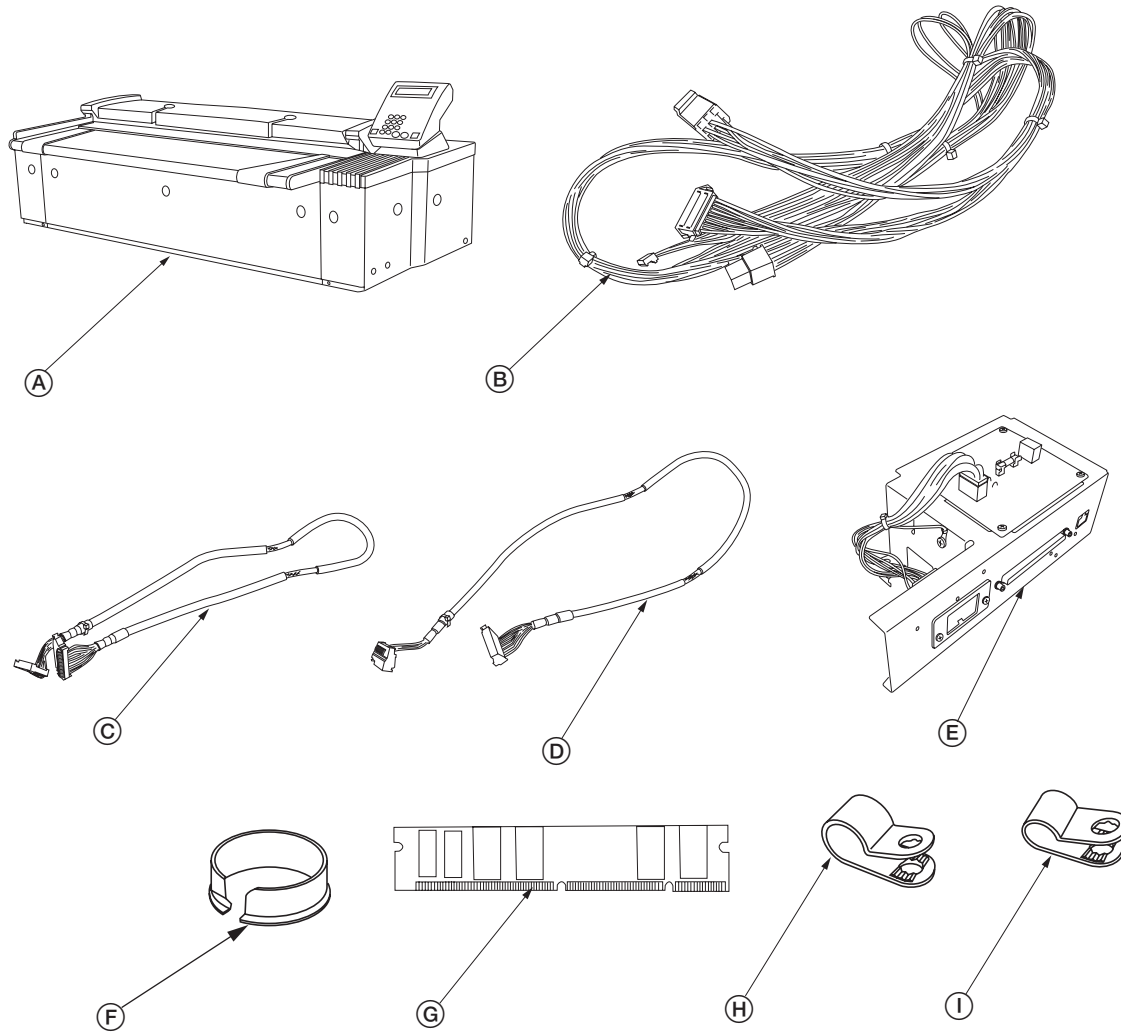

Package Contents

| | |
|---|---|
| Ⓐ KM-S4850w | 1 |
| Ⓑ Junction Wiring, Printer Unit | 1 |
| Ⓒ Junction Wiring, A, Interface PCB | 1 |
| Ⓓ Junction Wiring, B, Interface PCB | 1 |
| Ⓔ Scanner Interface PCB ASS'Y | 1 |
| Ⓕ Open Bushing OCB-100 | 1 |
| Ⓖ SD-RAM DIMM 128MB | 1 |
| Ⓗ Clamp, GNK-5N | 2 |
| Ⓖ Clamp, EMT-3N | 2 |
| Ⓙ M4X6 Binding Screws | 4 |

Important:

When disconnecting the power plug from the main body after installation, turn off the main switch of the main body and wait several seconds (more than five seconds) before disconnecting the plug. Do not disconnect the plug immediately.

NOTE: PROTECT the electronics by taking these precautions

Before touching the main circuit board and DIMM, touch a water pipe or other large metal object to discharge yourself of static electricity. While doing the work, it is recommended that you wear an antistatic wrist strap.

Ⓐ: The optional stand is not included in the product carton.

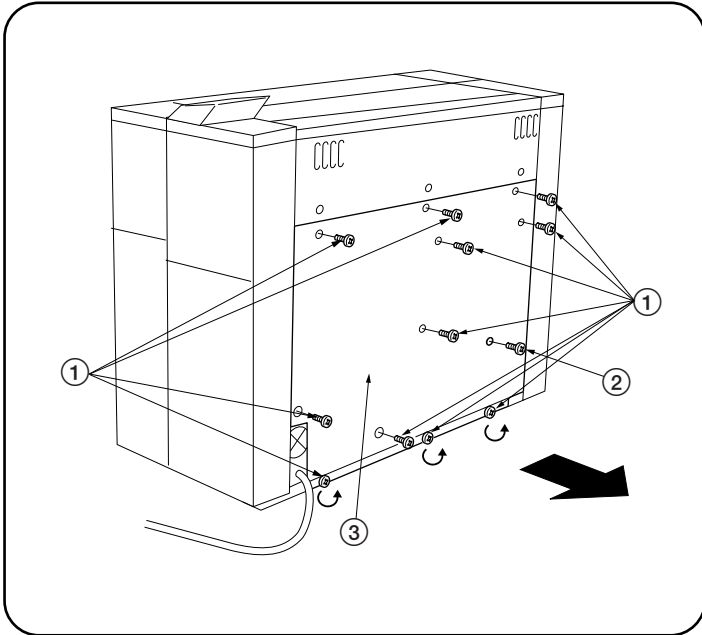

■Installation Procedure

* Turn the main unit main switch to OFF and unplug the main unit from the power supply and remove the Ethernet cable before starting this procedure.

1. Remove 8 screws (1) and M4X6 Raised Binding Screw(2), loosen the 3 screws at the bottom (1), and remove the rear cover (2).

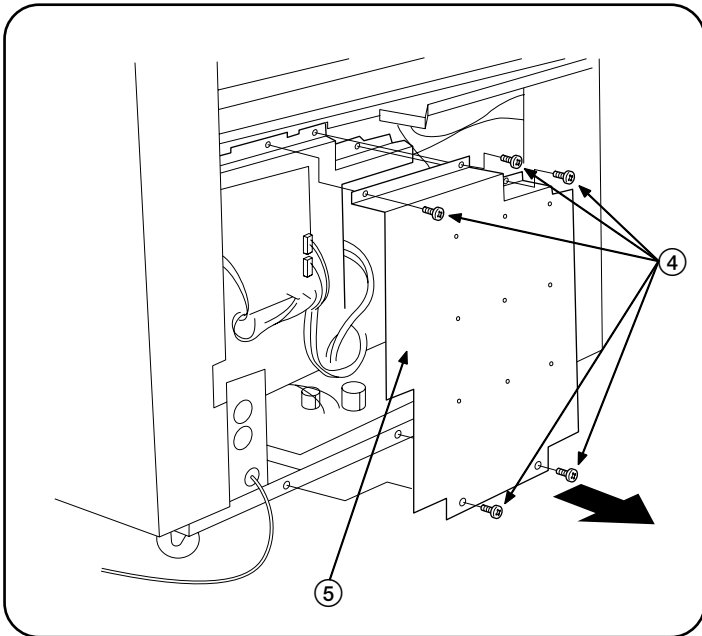

2. Remove 5 screws (4), and remove the main-PCB cover (5).

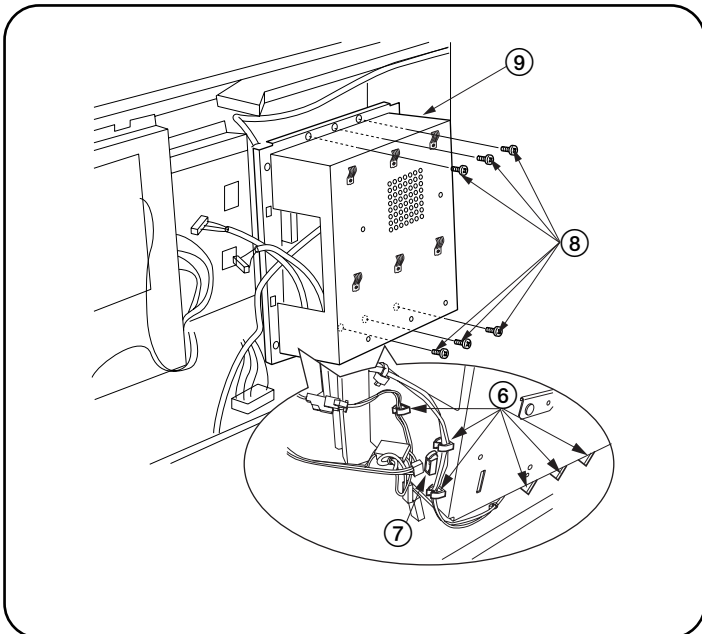

3. From the rear side of the main body, unlock the clamp (6) at the lower left of the controller cover located at the right side, remove the connector (7) and the six screws (8), and then remove the controller cover (9).

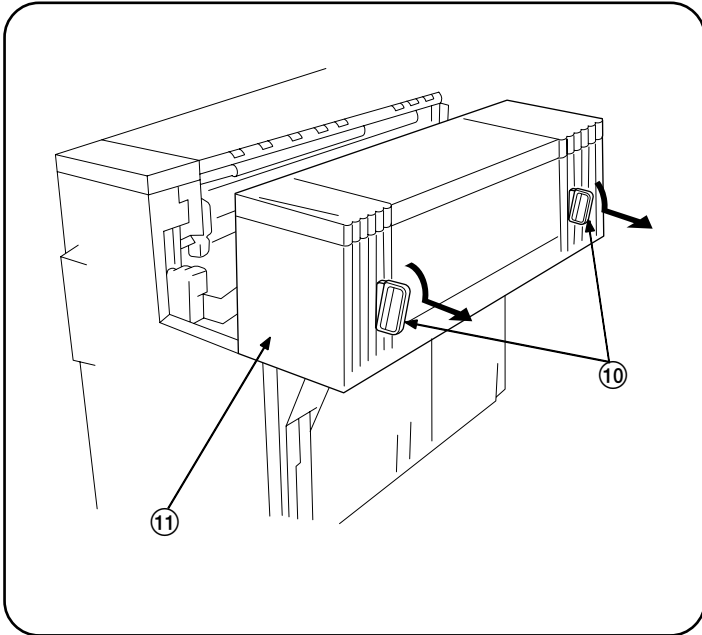

4. Lower the two levers ⑩ at the front of the main unit (pull them out and down), and pull out the attachment unit ⑪.

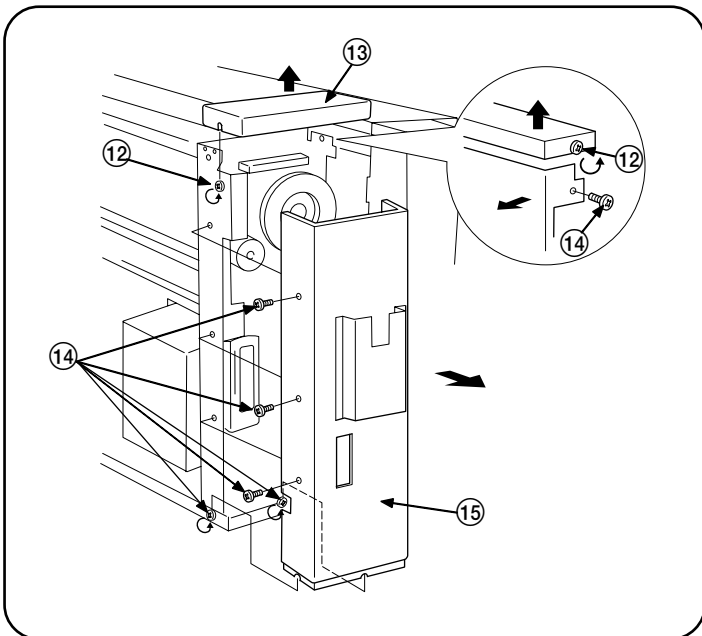

5. Loosen 2 screws ⑫ and remove the main unit's left rear upper cover ⑬.
6. Remove 4 screws ⑭, loosen 2 screws ⑭, and remove the main unit's left rear lower cover ⑮.

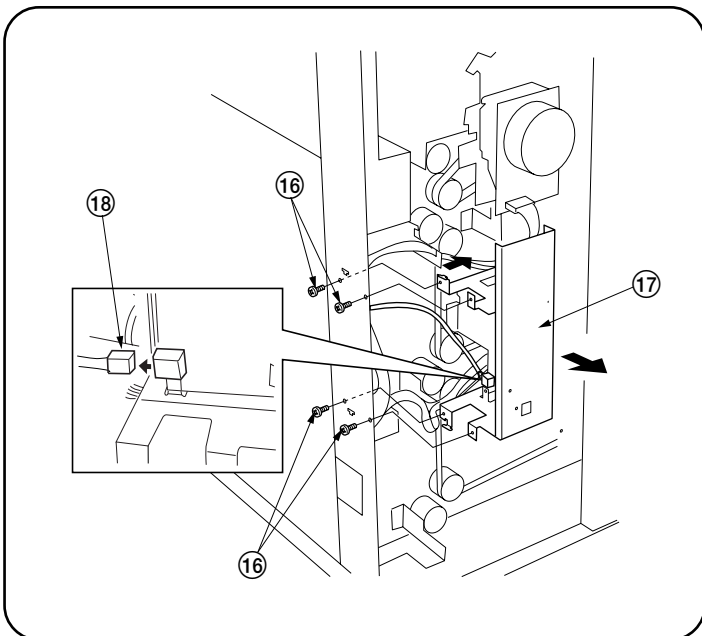

7. Remove 4 screws ⑯, and remove the scanner interface retainer ⑰.
8. Remove the Network connector ⑱.

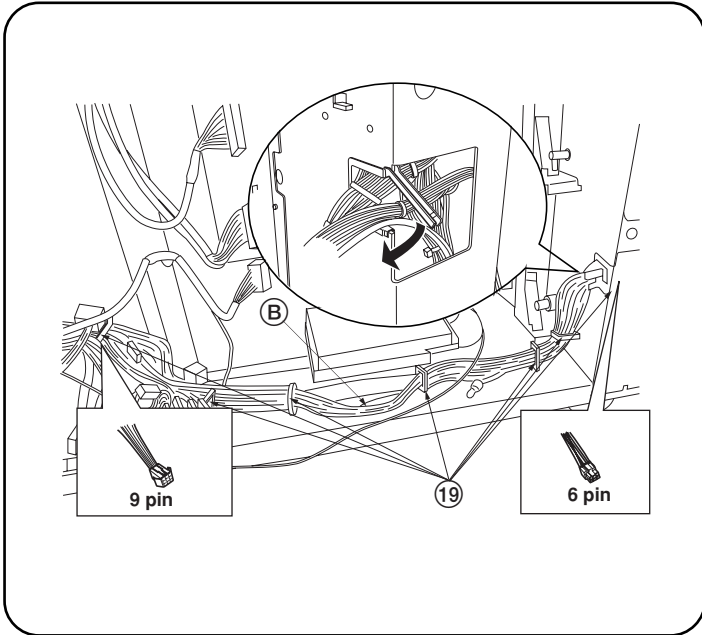

9. Put the 9-pin connector side of the Junction Wiring and Printer Unit (B) near the main PCB and the 6-pin connector side near the right side of the controller unit, and then lock the wire saddle (19) at seven locations and lay it down.

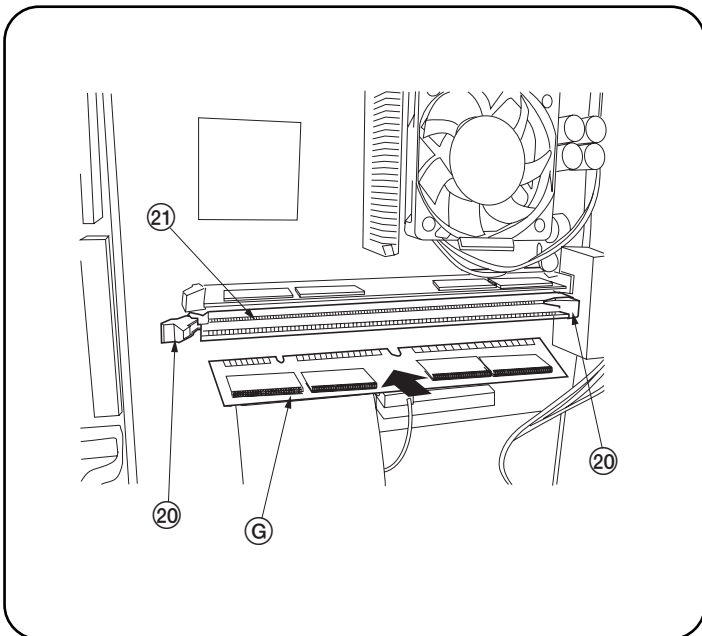

10. For KM-P4845w (Low Printer)

Insert DIMM (G) into the memory slot (21) of the controller unit until the hooks (20) on both sides are closed.

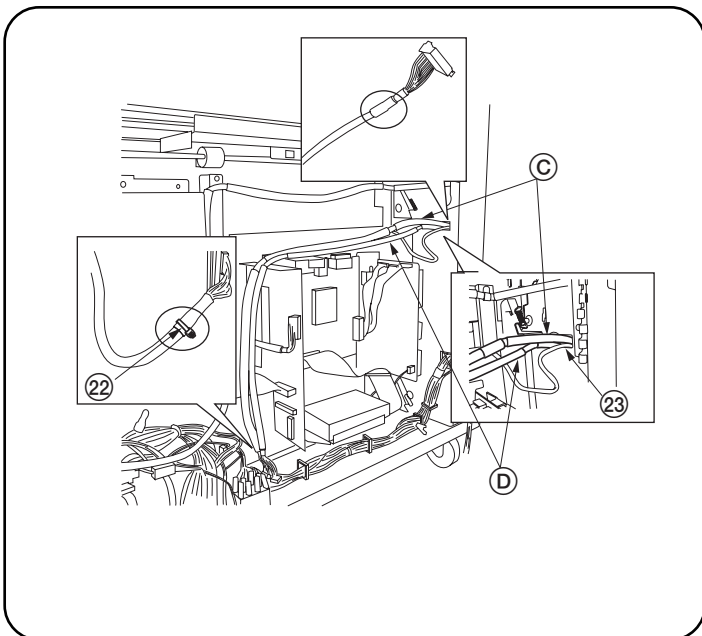

11. Put the connectors of the Junction Wiring A, Interface PCB (C) and the Junction Wiring B, Interface PCB (D) with a binding band (22) near the main PCB, and pass the connectors of the other side through the connection hole (23) on the main body.

* Pass the relay cable under the sheet metal so that the cable does not hit the spring.

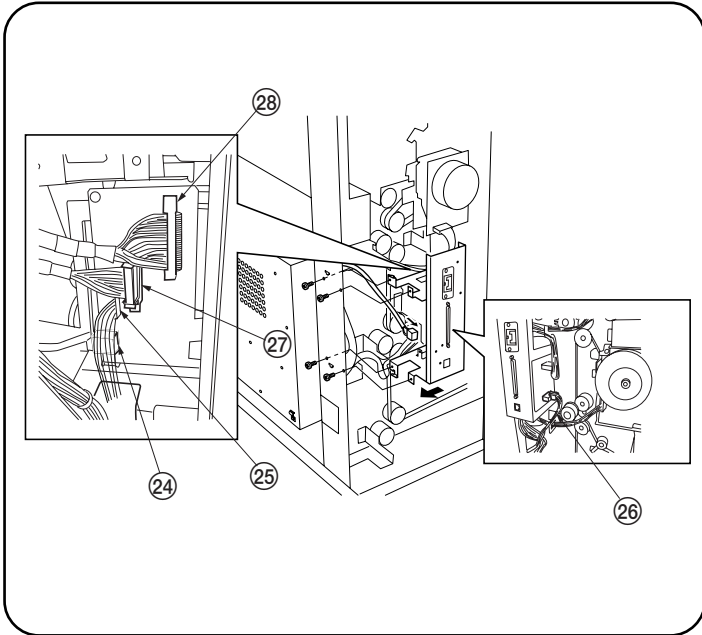

12. Connect the modular connector (24), Junction Wiring, Printer Unit (B) 10-pin connector (25), 6-pin connector (26) (on the front side of Scanner Interface PCB Assembly), Junction Wiring B, Interface PCB (D) (27), and Junction Wiring A, Interface PCB (C) (28) to the Scanner Interface PCB Assembly (E) described in step 11.

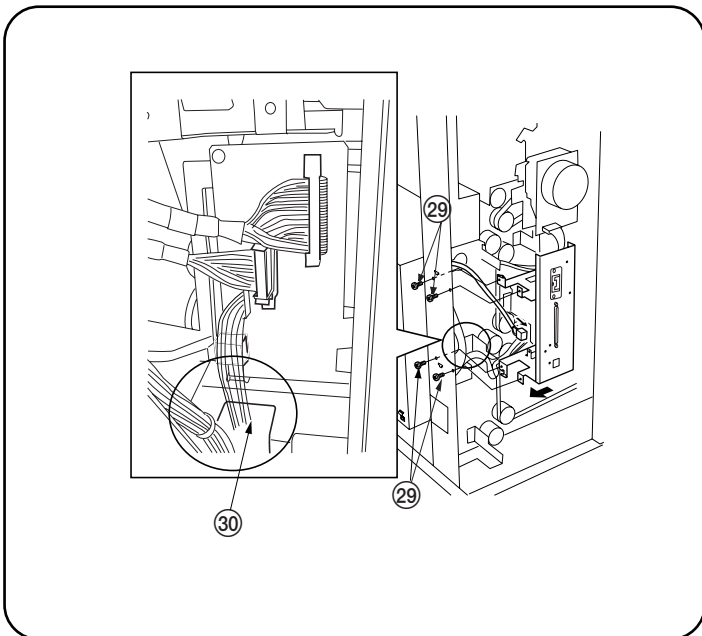

13. Fit the Scanner Interface PCB Assembly to the main body with four screws (29).

* When fitting, pass the cord (30) between the assembly and the main body so that the cord does not hit the connection portion of the Scanner Interface PCB Assembly (E).

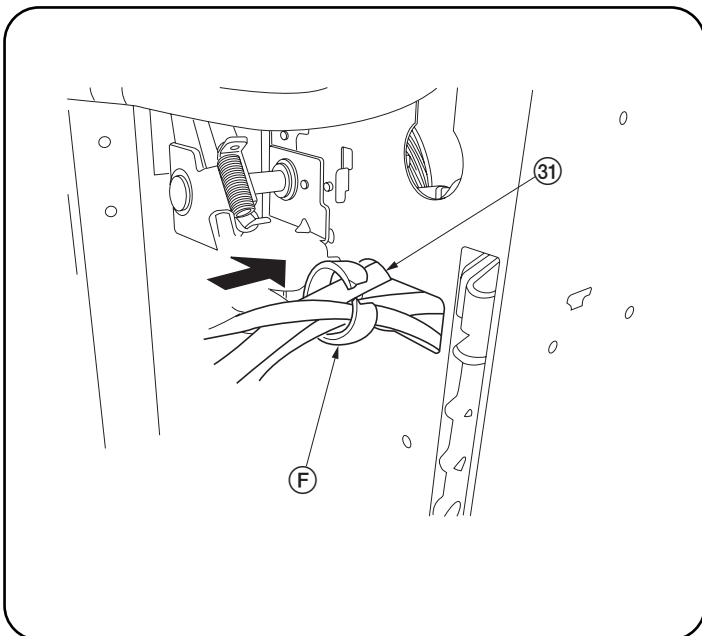

14. Pass the cable to be passed through the connection hole (31) at the rear right of the main body through the Open Bushing, OCB-1000 (F), and fit it to the connection hole (31).

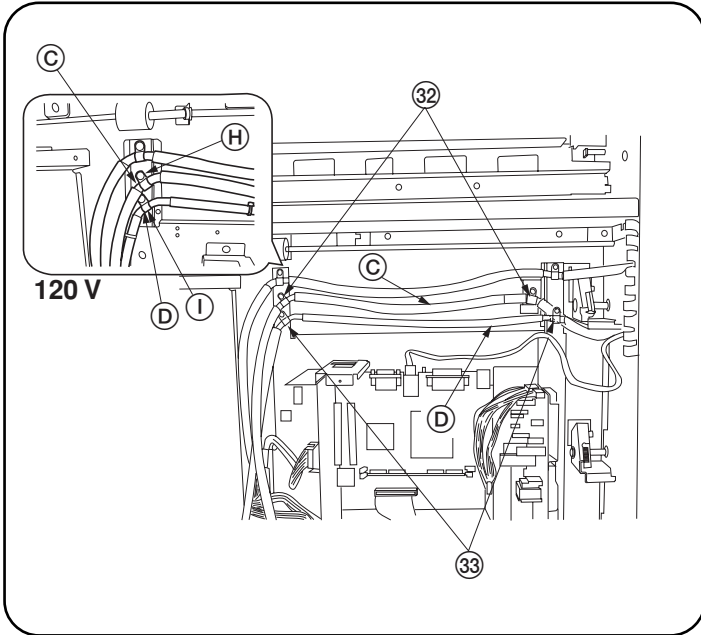

15A. (120 V specifications) Set the shaded area 32 of the Junction Wiring A, Interface PCB C with the clamp, GNK-5N H and the shaded area 33 of the Junction Wiring B, Interface PCB D with the clamp, EMT-3N I, and fix them with four binding screws M4 x 6 J.

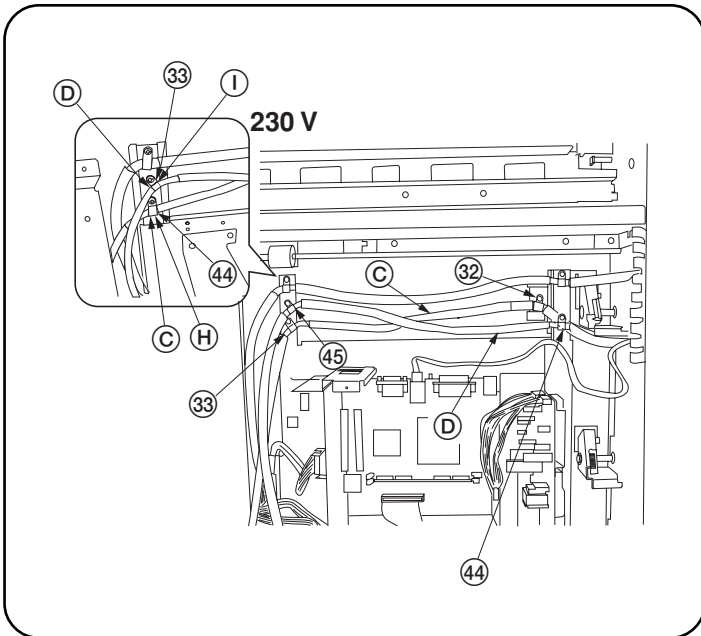

15B. (230 V specifications) Bind the Shaded area of the Junction Wiring A, interface PCB C with the CLAMP, GNK-5N H and at the upper right 32 and at the lower left 33, fix it with two binding screws M4x6 J. Bind the Shaded area of the Junction Wiring B, interface PCB D with the CLAMP, EMT-3N I and at the lower right 44 and at the upper left 45, fix it with two binding screws M4x6 J.

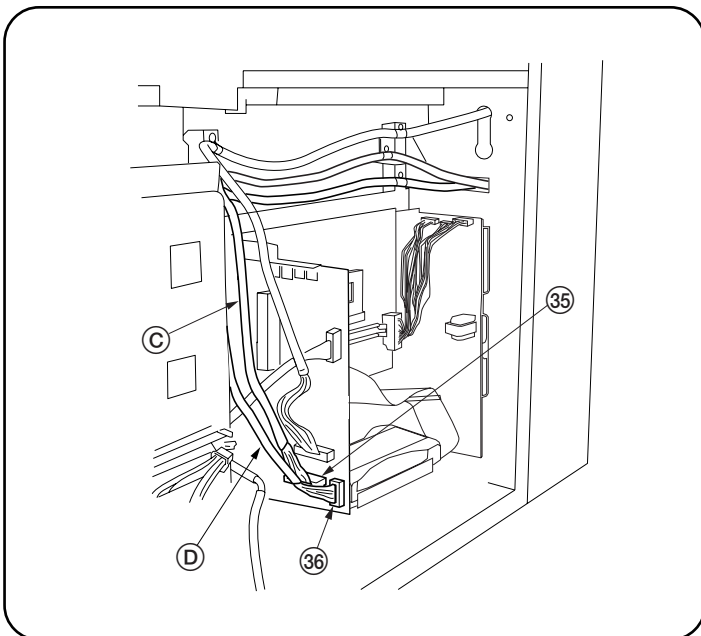

16A.(For 120V Specifications) Connect the Junction Wiring A, Interface PCB C with a binding band to CN5 35, and connect the Junction Wiring B, Interface PCB D with a binding band to CN4 36.

* When connecting them, support the IPU PCB with your hand.

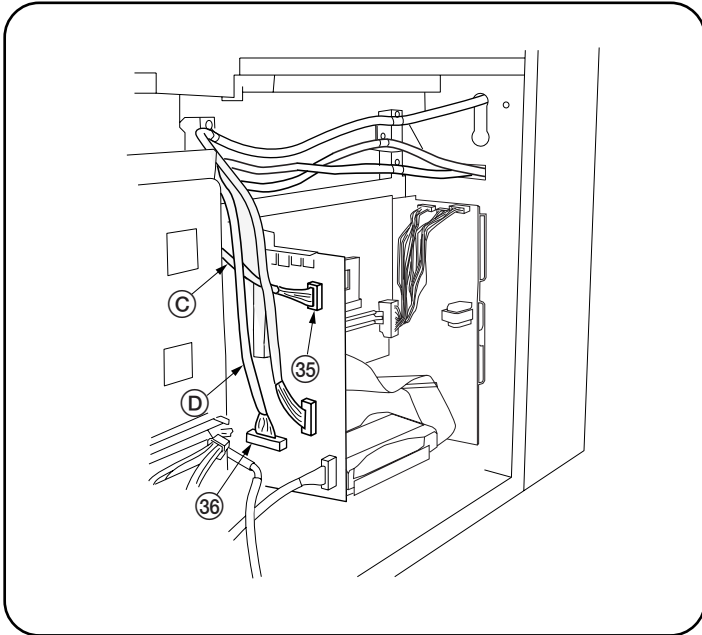

16B. (For 230V Specifications) On the plotter IPU PCB, connect the connector of the Junction Wiring B, Interface PCB (D) with a binding band to the JPEG connector (36), and connect the connector of the Junction Wiring A, Interface PCB (C) with a binding band to the Scanner connector (35).

* When connecting them, support the IPU PCB with your hand.

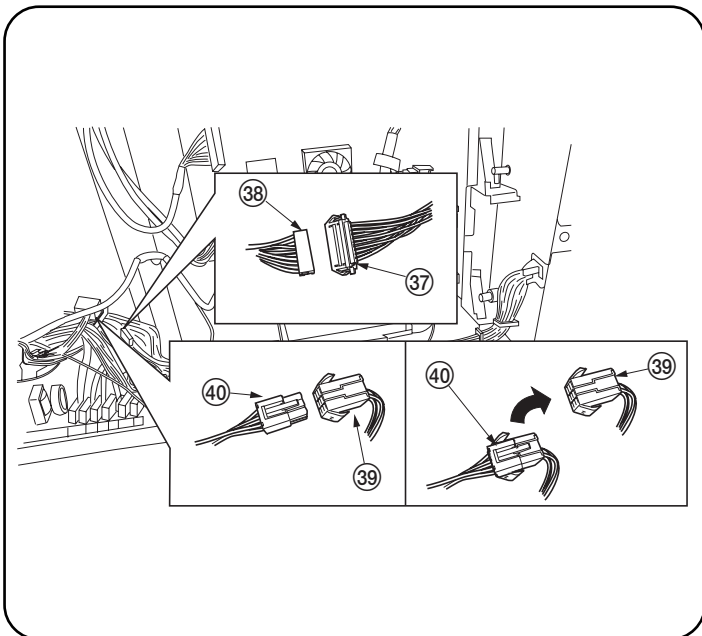

17. On the Junction Wiring, Printer Unit (B), connect the connector (38) at the lower part of the main PCB located at the rear of the main body to the 10-pin connector (37) and connect the connector (40) to the 9-pin connector (39).

* If the connector (40) has been already connected on the main body, disconnect it and then connect it to the Junction.

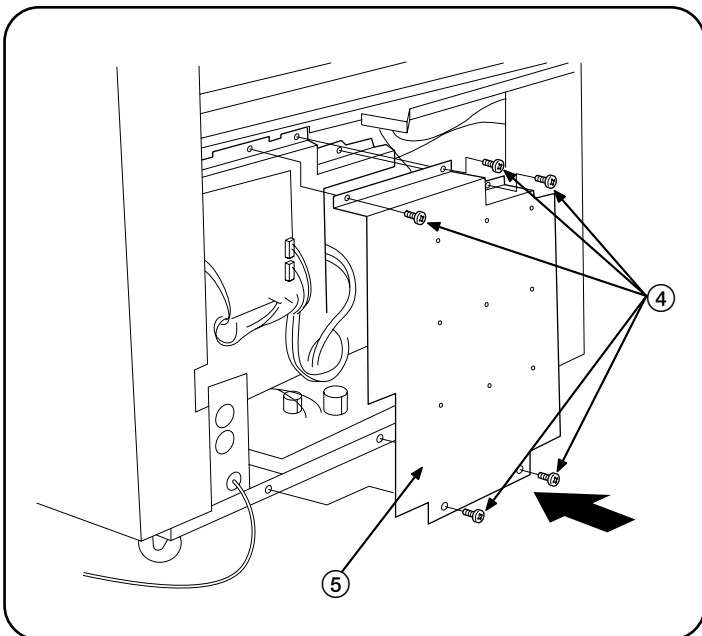

18. Reattach the main-PCB cover (5) with 5 screws (4).

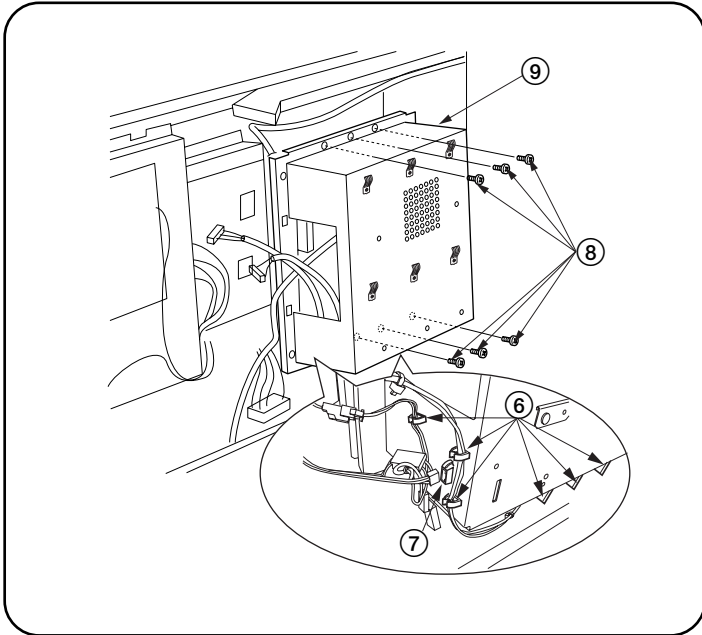

19. Fit the controller cover with six screws (8), lock the lower left six clamps (6) on the right controller cover from the rear side of the main body, and connect the connector (7).

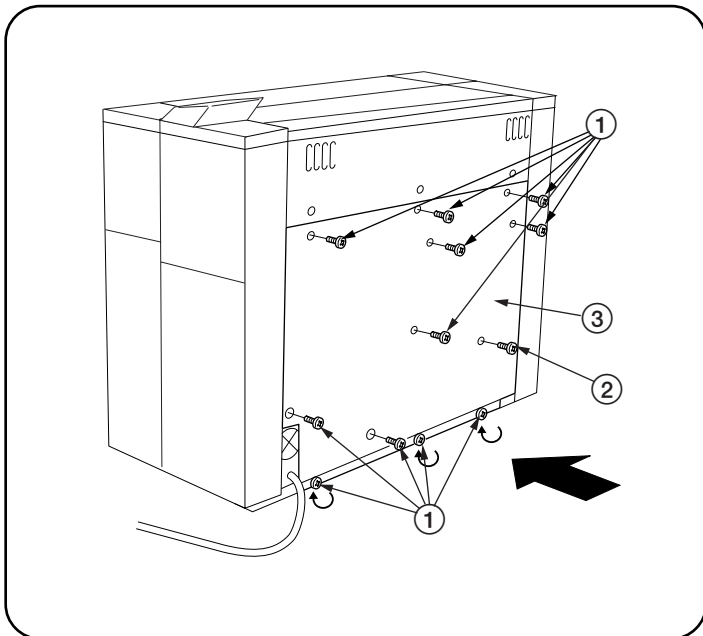

20. Reattach the rear cover (3), using 1 M4X6 Raised Binding Screws (2) and the 11 screws (1) that you removed or loosened at Step 1.

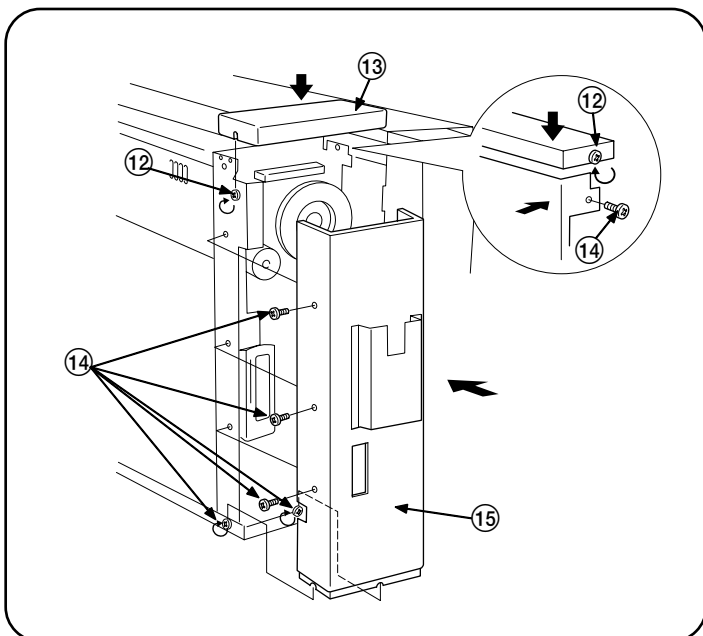

21. Reattach the main unit's left rear lower cover (15) with 6 screws (14).

22. Reattach the main unit's left rear upper cover (13) by tightening its 2 screws (12).

23. Close the attachment unit ⑪ securely.

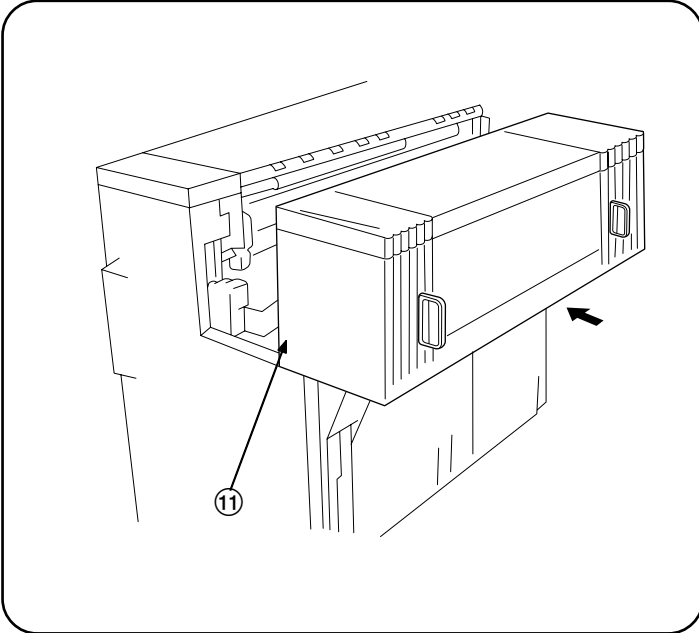

24. Connect the Ethernet cable ④③, the connector ④① and the connector ④② at the left rear of the main body respectively.

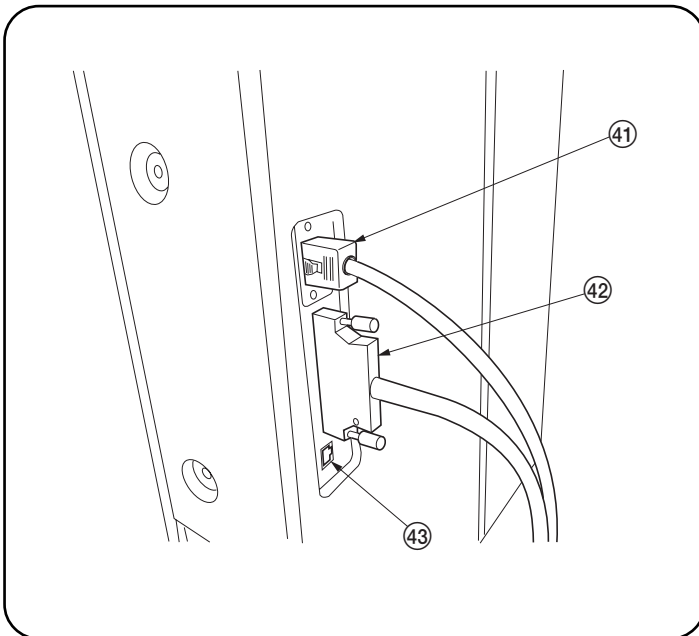

25. Execute Sim065, 066 and 067 on operation panel of this product, and then enter the value of data sheet with this product.

